

ENVIRONMENT PROTECTION LICENCE

(Pursuant to section 34 of the *Waste Management and Pollution Control Act*)

Licensee	Department of Health
Licence Number	EPL246 - 02
Registered Business Address	Department of Health 105 Rocklands Drive Tiwi NT 0810
ABN	84 085 734 992
Premises Address	Lot 09731 Town of Nightcliff plan(s) L2001/052B 105 ROCKLANDS DR, TIWI
Anniversary Date:	31 July
Commencement Date:	31/07/2022
Expiry Date:	30/07/2032
Scheduled Activity	<p>Collecting, transporting, storing, re-cycling, treating or disposing of a listed waste (as per Table 1) on a commercial or fee for service basis, other than in or for the purpose of a sewage treatment plant.</p> <p>Operating premises, other than a sewage treatment plant, associated with collecting, transporting, storing, re-cycling, treating or disposing of a listed waste (as per Table 1) on a commercial or fee for service basis.</p>
Description	<p>Operation of an Autoclave Clinical Waste Treatment Facility that is authorised to:</p> <ol style="list-style-type: none"> 1. Collect and transport listed waste (as per Table 1)

ENVIRONMENT PROTECTION LICENCE 246 - 02

2. Store

- a. Clinical and related waste in the form of cytotoxic waste
- b. Containers that are contaminated with residues of a listed waste.

3. Treat

- a. Clinical and related waste by steam sterilisation and autoclave processing*
- b. Containers that are contaminated with residues of a listed waste by bin washing plant.

* excluding those waste types defined as anatomical, cytotoxic and pharmaceutical wastes.

ENVIRONMENT PROTECTION LICENCE 246 - 02

Table 1 - Listed Wastes Authorised to be Handled

Listed Waste	Collection	Transport	Storage	Treatment	Recycling	Disposal
Containers that are contaminated with residues of a listed waste	✓	✓	✓	✓	✗	✗
Waste pharmaceuticals, waste drugs and waste medicines	✓	✓	✗	✗	✗	✗
Clinical and related wastes	✓	✓	✓	✓	✗	✗

✓ Activity authorised by this licence

✗ Activity not authorised by this licence

ENVIRONMENT PROTECTION LICENCE 246 - 02

TABLE OF CONTENTS

INFORMATION ABOUT THIS LICENCE	5
RULES FOR INTERPRETING THE CONDITIONS OF THIS LICENCE	7
LICENCE CONDITIONS	8
GENERAL	8
EARLY SURRENDER OF LICENCE	9
OPERATIONAL	9
DISCHARGES AND EMISSIONS	10
MONITORING	11
RECORDING AND REPORTING	11
DEFINITIONS	14

ATTACHMENTS

- 1 Site Layout Plan.pdf

ENVIRONMENT PROTECTION LICENCE 246 - 02

INFORMATION ABOUT THIS LICENCE

- This licence does not in any way relieve the licence holder from its obligations to comply with the *Waste Management and Pollution Control Act* (WMPC Act), including the general environmental duty in section 12 of the WMPC Act and the duty to notify of incidents causing or threatening to cause pollution under section 14 of the WMPC Act.

Duration of a licence (section 40, 43 and 45 of the WMPC Act)

- A licence will remain in force until its expiry date or until it is surrendered by the licensee or is suspended or cancelled in accordance with the WMPC Act.
- The licensee must notify the Northern Territory Environment Protection Authority (NT EPA) within 14 days after ceasing to conduct the activity.
- The licensee may, with the approval of the NT EPA, surrender the licence to the NT EPA.

Amendment or Revocation of a licence (section 37 of the WMPC Act)

- The licensee may apply to amend or revoke a condition of this licence.
- A fee applies and the application must be made using the designated form via NT EPA Online.
- The NT EPA may also amend or revoke a condition of this licence as set out in section 38 of the WMPC Act.

Transfer of a licence (section 46 of the WMPC Act)

- The licensee can apply to transfer their licence to another person.

Renewal of a licence (section 40 of the WMPC Act and section 3 of the Regulations)

- The licensee may apply for the renewal of their licence not earlier than 90 days, and not later than 30 days, before their licence expires.
- A fee applies and the application must be made via NT EPA Online.

Public Register

- A copy of environment protection licences and any plans for environmental management, reports, submissions or documents required as a condition of an environment protection licence, will be placed on a register in accordance with section 9 of the WMPC Act.
- A copy of the Annual Return will be placed on the register.
- The NT EPA makes this register freely available from the NT EPA website.

Environment Protection Objectives (Part 4 of the WMPC Act), and Water Quality Standards (section 73 of the *Water Act*)

- An Environment Protection Objective (EPO) is a statutory instrument to establish principles on which:
 - a. environmental quality is to be maintained, enhanced, managed or protected;
 - b. pollution, or environmental harm resulting from pollution, is to be assessed, prevented, reduced, controlled, rectified or cleaned up; and
 - c. effective waste management is to be implemented or evaluated.
- In accordance with section 18 of the WMPC Act a beneficial use, quality standard, criteria or objective declared under section 73 of the *Water Act* and in force is an environment protection objective for the purposes of the WMPC Act.

ENVIRONMENT PROTECTION LICENCE 246 - 02

- The following EPOs and Beneficial Use Declarations (BUDs) are relevant to this licence:
 - Declared Beneficial Use for the Darwin Harbour Area: Water Quality Objectives, Gazette 29 June 2010.

Environmental Interests

- This section highlights sensitivity of the surrounding land use and environment associated with the location of the approved activity.
- Sites of Conservation Significance
- Ramsar Wetland

Cultural Interests

- It is the licensee's responsibility to contact the Aboriginal Areas Protection Authority, appropriate land council or other governing body and ensure that any Authority Certificates required as a result of conducting the licenced activity are obtained and complied with.

ENVIRONMENT PROTECTION LICENCE 246 - 02

RULES FOR INTERPRETING THE CONDITIONS OF THIS LICENCE

- Where there is a discrepancy between the conditions of this licence and any plan, standard, guideline or other document referred to in this licence, the conditions of this licence prevail to the extent of the inconsistency.
- Any reference to any standard (Australian or international) in this licence means the relevant parts of the current version of that standard.
- A reference to any guideline or code of practice (or to the relevant parts of any guideline or code of practice) in this licence means the current version of the guideline or code of practice.
- Under section 39 of the WMPC Act, any contravention of or failure to comply with this licence by the licensee may be an offence.
- In determining whether the licensee has committed an offence, the licensee may be liable for the conduct of its directors, employees or agents.
- The licensee should ensure that each of its directors, employees, contractors or agents are aware of, and comply with, this licence.
- In this licence, unless the contrary intention appears, words that are defined in the WMPC Act are intended to have the meaning given to them in that Act.

ENVIRONMENT PROTECTION LICENCE 246 - 02

LICENCE CONDITIONS

GENERAL

- 1 The licensee must ensure the contact details recorded in NT EPA Online for this licence are correct at all times.
- 2 The licensee must at all times have a 24 hour emergency contact.
- 3 The licensee must pay via NT EPA Online the annual fee calculated in accordance with the method prescribed in the Regulations within 10 business days of the anniversary date of this licence, for each year or part of a year that this licence is in force.
- 4 The licensee must cause clear and legible signage, in English, to be displayed in a prominent location at each public entrance to the premises that includes the following details:
 - 4.1 environment protection licence number issued under the WMPC Act; and
 - 4.2 24 hour emergency contact details.
- 5 The licensee must cause a copy of this licence to be available for inspection by any person, in hard copy form, at the premises.
- 6 The licensee must provide to the NT EPA, within 10 business days of a request, a copy of any document, monitoring data or other information in relation to the activity, in the format requested by the NT EPA.
- 7 All notices, reports, documents or other correspondence required to be provided as a condition of this licence, unless otherwise specified as a condition of this licence, must be provided in electronic form by uploading the document via NT EPA Online (or by emailing waste@nt.gov.au).
- 8 The licensee must implement, maintain and follow the documents listed in Table 2.

Table 2 - Documents Relevant to the Licenced Activity

Reference	Document
RDH 2018	Environmental Management Plan
EDOC 2020 / 372096	Emergency Response Plan

- 9 Within 10 business days of any amendment being made to a document listed in Table 2 the licensee must provide the amended document to the NT EPA, along with:
 - 9.1 a tabulated summary of the amendment(s) with document references;
 - 9.2 reasons for the amendment(s); and
 - 9.3 an assessment of environmental risk associated with the amendment(s).
- 10 The NT EPA may require the licensee to revise or amend and resubmit any amended document. Where the NT EPA requires a document to be resubmitted, the licensee must submit it to the NT EPA by the date specified by the NT EPA.
- 11 The licensee must maintain a Complaint Log for all complaints received by the licensee in relation to the activity.
- 12 The licensee must ensure that the Complaint Log includes, for each complaint received by the licensee, the following information:

ENVIRONMENT PROTECTION LICENCE 246 - 02

- 12.1 the person to whom the complaint was made;
 - 12.2 the person responsible for managing the complaint;
 - 12.3 the date and time the complaint was reported;
 - 12.4 the date and time of the event(s) that led to the complaint;
 - 12.5 the contact details of the complainant if known, or where no details are provided a note to that effect;
 - 12.6 the nature of the complaint;
 - 12.7 the nature of event(s) giving rise to the complaint;
 - 12.8 prevailing weather conditions at the time (where relevant to the complaint);
 - 12.9 the action taken in relation to the complaint, including any follow-up contact with the complainant; and
 - 12.10 if no action was taken, why no action was taken.
- 13 The licensee must implement, maintain and follow an Emergency Response Plan that addresses procedures for responding to emergencies associated with the activity that may cause environmental harm.

EARLY SURRENDER OF LICENCE

- 14 Any reports, records or other information required or able to be provided by the licensee under this licence must be submitted to the NT EPA prior to the licensee surrendering the licence. If the date on which a report, record or other information is required falls after the date the licensee requests to surrender this licence, the licensee must provide the report, record or information as far as possible using data available to the licensee up to and including the date the request to surrender the licence is made.

OPERATIONAL

- 15 The licensee must not collect, transport, store, recycle, treat or dispose of listed waste other than the listed waste specified in Table 1.
- 16 The licensee must cause listed waste received as Clinical and Related Waste to be treated by autoclave for a minimum of 40 minutes at a minimum core temperature of 140°C and in accordance with *AS3816: 2018 – Management of Clinical and Related Wastes* and *AS/NZS 4187:2014 Amendment 2 – Reprocessing of reusable medical devices in health service organizations*.
- 17 The licensee must conduct performance validation testing on the autoclave a minimum of once per annum and provide a copy of the Performance Qualification (PQ) Test Report to the NT EPA upon receipt.
- 18 The licensee must conduct maintenance and monitoring of the autoclave in accordance with the manufacturer's specifications and recommendations.
- 19 The licensee must ensure any plant and equipment used by the licensee in conducting the activity:
- 19.1 is reasonably fit for the purpose and use to which it is put;
 - 19.2 is maintained;
 - 19.3 is operated by a person trained to use the plant and equipment; and

ENVIRONMENT PROTECTION LICENCE 246 - 02

- 19.4 is operated by, or operated by a person accompanied by, a person trained to handle, store or dispose of listed waste in connection with the activity.
- 20 The licensee must ensure that accurate information about all vehicles used by the licensee in conducting the activity is maintained on the NT EPA Online Vehicle Register.
- 21 The licensee must cause to be carried with the vehicle used to transport listed waste:
- 21.1 a legible copy of this licence;
 - 21.2 a legible manifest of the load being carried;
 - 21.3 spill response equipment; and
 - 21.4 for interstate transport, a waste transport certificate.
- 22 The licensee must cause listed waste to be transported in a manner that ensures listed wastes do not escape, spill or leak from the transport vehicle at any time.
- 23 The licensee must ensure that wastewater generated from washing plant and equipment associated with the activity does not cause pollution.
- 24 The licensee must ensure that all materials that are likely to cause environmental harm are handled and stored in areas with a containment system in accordance with the relevant Australian Standard. Where no relevant Australian Standard exists, the containment system must be sized to contain 110% of the volume of the largest container within the area.
- 25 The licensee must not store more than 500 kilograms of *clinical and related waste* in the form of cytotoxic waste at the premises at any one time.
- 26 The licensee must keep a log of all listed waste stored at the premises, which includes the following information:
- 26.1 storage container identification;
 - 26.2 date stored;
 - 26.3 duration of storage;
 - 26.4 quantity stored; and
 - 26.5 nature of material.
- 27 The licensee must ensure that all listed waste being transported to and from the premises is transported by a person licenced under section 30 of the WMPC Act to transport the listed waste.
- 28 The licensee must ensure that all listed waste is delivered to a premises licenced under section 30 of the WMPC Act to receive that listed waste.
- 29 The licensee must comply with the National Environment Protection (Movement of Controlled Wastes between States and Territories) Measure 1998.

DISCHARGES AND EMISSIONS

- 30 The licensee must ensure there is no migration or overflow of a contaminant or waste, which causes or may cause environmental harm, beyond the boundary of the land on which the premises are located. (For the avoidance of doubt, this condition is not intended to authorise the discharge of a contaminant or

ENVIRONMENT PROTECTION LICENCE 246 - 02

waste to any land or water which discharge has not been specifically authorised by another condition of this licence.)

- 31 The licensee must not allow a contaminant or waste, which causes or may cause environmental harm, to enter water.
- 32 The licensee must ensure that stormwater does not come into contact with a contaminant or waste, which causes or may cause environmental harm.
- 33 The activity must not cause or release, beyond the boundary of the premises:
 - 33.1 smoke;
 - 33.2 offensive odour;
 - 33.3 dust or particulates; or
 - 33.4 noise which unreasonably interferes with or is likely to unreasonably interfere with the enjoyment of the area by persons who occupy a place within the area or are otherwise lawfully in the area.

Licence Audit

- 34 The licensee must undertake a licence audit by a qualified person, to evaluate the extent to which the licensee is compliant with all the conditions of this licence on a biennial basis.
- 35 The licensee must ensure that, for each licence audit undertaken by the licensee:
 - 35.1 a written report is prepared and signed by the qualified person who conducted the audit; and
 - 35.2 the written report is provided in full to the NT EPA within 5 business days of being signed by the qualified person, and shall be submitted no later than 10 business days after the anniversary date for the Annual Reporting period for which the licence audit relates.

MONITORING

- 36 There are no specified conditions relating to monitoring of point source discharges in this licence.

RECORDING AND REPORTING

- 37 The licensee must keep and maintain records relating to the activity undertaken and the listed waste handled by the licensee in each successive 12 month period following the commencement of this licence, which include:
 - 37.1 the date of collection;
 - 37.2 the source of the listed waste;
 - 37.3 the name of the transport company, if not the licensee;
 - 37.4 the vehicle registration;
 - 37.5 a description of the listed waste;
 - 37.6 the quantity of the listed waste;
 - 37.7 the final destination of the listed waste; and
 - 37.8 whether the listed waste was stored, recycled, treated or disposed of.
- 38 The licensee must retain records relating to waste, including listed waste, as required by the conditions

ENVIRONMENT PROTECTION LICENCE 246 - 02

of this licence, for a period of 2 years after the end of the 12 month period to which the record relates.

- 39 The licensee must keep records of all non-compliances with this licence. These records must be adequate to enable the licensee to comply with the non-compliance notification conditions of this licence.
- 40 The licensee must notify the NT EPA of any non-compliance with this licence by completing the Non-Compliance Notification via NT EPA Online (or by emailing waste@nt.gov.au), as soon as practicable after (and in any case within 24 hours after) first becoming aware of the non-compliance.
- 41 The licensee must include in the notification of non-compliance the following information:
- 41.1 when the non-compliance was detected and by whom;
 - 41.2 the date and time of the non-compliance;
 - 41.3 the actual and potential causes and contributing factors to the non-compliance;
 - 41.4 the risk of environmental harm arising from the non-compliance;
 - 41.5 the action(s) that have or will be undertaken to mitigate any environmental harm arising from the non-compliance;
 - 41.6 corrective actions that have or will be undertaken to ensure the non-compliance does not reoccur;
 - 41.7 if no action was taken, why no action was taken; and
 - 41.8 a date when an incident investigation report will be submitted to the NT EPA.
- 42 The licensee must submit a completed Annual Return form to waste@nt.gov.au within 10 business days after each anniversary date of this licence, which relates to the preceding 12 month period.

ENVIRONMENT PROTECTION LICENCE 246 - 02

END OF LICENCE CONDITIONS

This licence is not valid unless signed below:



Peter Vasel
Director Environmental Operations
Delegate of the Northern Territory
Environment Protection Authority
Dated: 12/10/2022

END NOTES

This licence is a renewal of EPL246-01

EPL246-01 was a renewal that replaced EPL246 on 31 July 2020, and expired on 30 July 2022

EPL246 was a renewal that replaced EPL100 on 31 July 2018, and expired on 30 July 2020

EPL100 was issued on 8 April 2013 with an expiry date of 8 April 2018.

ENVIRONMENT PROTECTION LICENCE 246 - 02

DEFINITIONS

All terms in the Licence which are defined in the *Waste Management and Pollution Control Act* have the meaning given in that Act unless otherwise or further defined in this section.

DEFINITION	In this licence, unless a contrary intention appears:
24 hour emergency contact	the phone number of a person who can be contacted at any time and be capable of responding to and providing information about any incident associated with the activity.
Activity	the Scheduled activity as described on the covering page of this licence.
Air	includes any layer of the atmosphere.
Annual fee	yearly fee payable in respect of the activity as specified in the WMPC Act and the Regulations.
Annual Return	an NT EPA prescribed format for demonstrating and reporting compliance with the conditions of this licence and providing information on waste volumes for the preceding 12 month period.
Business days	a day not Saturday, Sunday or a public holiday, in the Northern Territory.
Complaint Log	a register of complaints to be maintained by the Licensee that records the details of each complaint received in relation to the activity.
Consultation and Communication Plan	a written plan documenting proposed consultation and communications for the activity before, during and after the activity which includes a strategy for communicating with members of the public who are likely to have a real interest in, or be affected by, the activity.
Contact details	includes the 24 hour emergency contact, and name, position title and phone number of a representative of the licensee who can be contacted about the licence and activity.
Contaminant	a solid, liquid or gas or any combination of such substances and includes: (a) noise, odour, heat and electromagnetic radiation; (b) a prescribed substance or prescribed class of substances; and (c) a substance having a prescribed property or prescribed class of properties.
Discharges	allow a liquid, gas or other substance to flow out from where it has been confined.
Emergency Response Plan	a written plan documenting the licensee's procedures for responding to emergencies caused by, resulting from or associated with the activity and that may cause environmental harm.
Environmental audit	has the meaning given in section 47 of the WMPC Act.
Environmental harm	(a) any harm to or adverse effect on the environment; or (b) any potential harm (including the risk of harm and future harm) to or potential adverse effect on the environment, of any degree or duration and includes environmental nuisance.
Environmental nuisance	means: (a) an adverse effect on the amenity of an area that: (i) is caused by noise, smoke, dust, fumes or odour; and (ii) unreasonably interferes with or is likely to unreasonably interfere with the

ENVIRONMENT PROTECTION LICENCE 246 - 02

enjoyment of the area by persons who occupy a place within the area or are otherwise lawfully in the area; or
(b) an unsightly or offensive condition caused by contaminants or waste.

Incident	includes: (a) an accident, emergency or malfunction; and (b) a deliberate action, whether or not that action was taken by the person conducting the activity in the course of which the incident occurred.
Land	includes water and air on, above or under land.
Landfill cell	a purpose built area for the disposal of waste within a landfill.
Leachate	any liquid produced by the action of water percolating through waste, and that contains contaminants.
Listed waste	a waste included under Schedule 2 of the Regulations.
Litter	litter, garbage, rubbish, refuse or waste matter, and includes the body of a dead animal.
Maintain	kept in a manner that it does not present or cause a risk of environmental harm or a hazard to persons or property or, for the purposes of documents including plans, a process of reviewing and amending documentation to ensure it is relevant.
Material environmental harm	environmental harm that: (a) is not trivial or negligible in nature; (b) consists of an environmental nuisance of a high impact or on a wide scale; (c) results, or is likely to result, in not more than \$50,000 or the prescribed amount (whichever is greater) being spent in taking appropriate action to prevent or minimise the environmental harm or rehabilitate the environment; or (d) results in actual or potential loss or damage to the value of not more than \$50,000 or the prescribed amount (whichever is greater).
Non-compliance	failure or refusal to comply, whether by act or omission, with obligations or requirements and includes any exceedance of a licence limit.
Non-compliance notification	an NT EPA prescribed format for notifying the NT EPA of a non-compliance.
NT EPA Online	online system for Environment Protection Licence (EPL), Environment Protection Approval (EPA) and Waste Discharge Licence (WDL) lodgement and maintenance.
NT EPA Online Vehicle Register	the vehicle register found at NT EPA Online.
Plant and equipment	all material items used in association with the activity, including (but not limited to) storage vessels and containers, pipe work and hosing, vehicles (including vessels), tools, and measuring equipment.
Point source discharge	means any discernible, confined or discrete conveyance from which contaminants or waste are or may be discharged.
Pollute	(a) emit, discharge, deposit, or disturb, directly or indirectly, a contaminant or waste; or (b) cause, permit, or fail to prevent, directly or indirectly, the emission, discharge, deposition, disturbance or escape of a contaminant or waste.
Pollution	(a) a contaminant or waste that is emitted, discharged, deposited or disturbed or that escapes; or

ENVIRONMENT PROTECTION LICENCE 246 - 02

(b) a contaminant or waste, effect or phenomenon, that is present in the environment as a consequence of an emission, discharge, deposition, escape or disturbance or a contaminant or waste.

Premises	the premises identified in this licence which includes equipment, plant and structures, whether stationary or portable, and the land on which premises are situated.
Public entrance	access to the premises that is utilised by the public.
Qualified person	a person registered under Section 68 of the WMPC Act.
Regulations	<i>Waste Management and Pollution Control (Administration) Regulations.</i>
Serious environmental harm	environmental harm that is more serious than material environmental harm and includes environmental harm that: (a) is irreversible or otherwise of a high impact or on a wide scale; (b) damages an aspect of the environment that is of a high conservation value, high cultural value or high community value or is of special significance; (c) results or is likely to result in more than \$50,000 or the prescribed amount (whichever is greater) being spent in taking appropriate action to prevent or minimise the environmental harm or rehabilitate the environment; or (d) results in actual or potential loss or damage to the value of more than \$50,000 or the prescribed amount (whichever is greater).
Solid inert waste	solid waste that has no active chemical or biological properties. These wastes do not undergo environmentally significant physical, chemical or biological transformation.
Stormwater	water flowing over ground surfaces, in natural streams and drains as a direct result of rainfall over a catchment and consists primarily of rainfall runoff.
Waste	(a) a solid, a liquid or a gas; or (b) a mixture of such substances, that is or are left over, surplus or an unwanted by-product from any activity (whether or not the substance is of value) and includes a prescribed substance or class of substances.
Waste transport certificate	the NT EPA waste tracking documentation used to track listed waste being transported interstate as required in accordance with the National Environment Protection (Movement of Controlled Waste Between States and Territories) Measure.
Wastewater	water that contains a contaminant or waste.
Water	includes: (a) surface water, ground water and tidal waters; (b) coastal waters of the Territory, within the meaning of the <i>Coastal Waters (Northern Territory Powers) Act 1980</i> of the Commonwealth; and (c) water containing an impurity.
WMPC Act	the Northern Territory <i>Waste Management and Pollution Control Act.</i>



ON
SERVICES & STORES BLD 10

VESALIUS ROAD

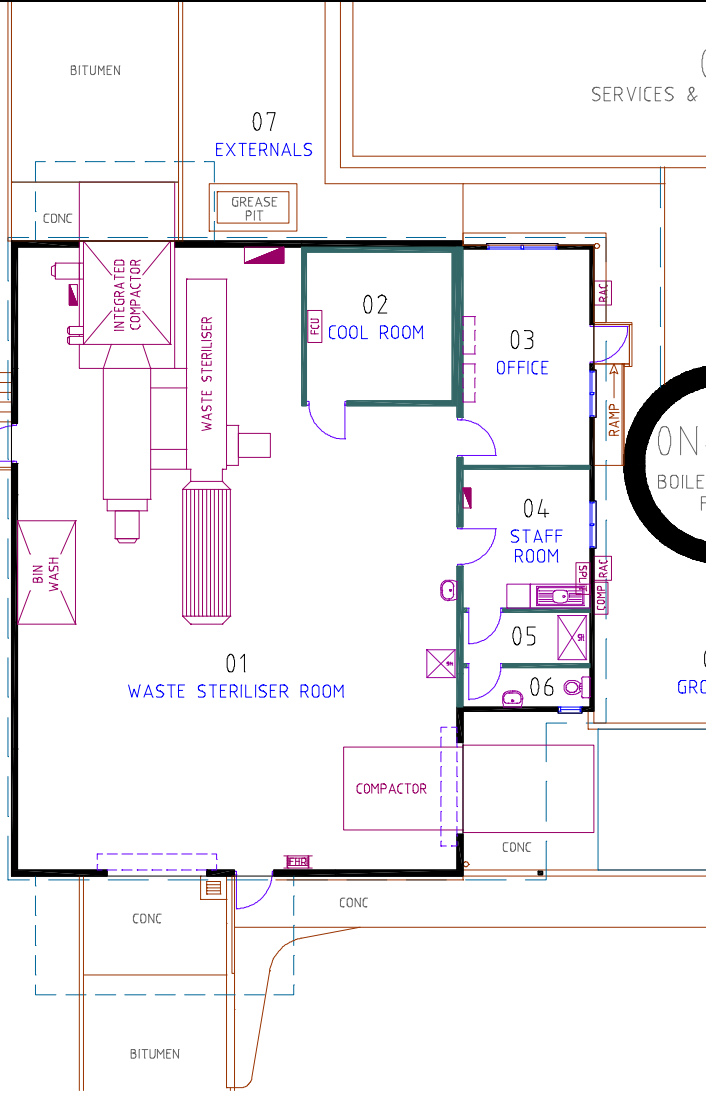

ROYAL DARWIN HOSPITAL
WASTE MANAGEMENT BLDG

Tiwi
Address:

Lot: 09731
AMS NUMBER
NTB-00123-01

floor plan

001231